

THIS DRAWING IS UNPUBLISHED. RELEASED FOR PUBLICATION  
 © COPYRIGHT BY TYCO ELECTRONICS CORPORATION. ALL RIGHTS RESERVED.

| LOC | DIST | REVISIONS   |                           |         |        |
|-----|------|-------------|---------------------------|---------|--------|
| P   | LTR  | DESCRIPTION | DATE                      | DWN     | APVD   |
| CM  | 00   | R           | REV PER ECO-07-003704     | 21FEB07 | KW DB  |
|     |      | R1          | REVISED PER ECO-09-023313 | 12OCT09 | KK AEG |

| YES      | DIM A        | NO. OF CIRCUITS | PART NO.              |
|----------|--------------|-----------------|-----------------------|
| YES      | 71.12[2.800] | 28              | 5-640620-8            |
| YES      | 68.58[2.700] | 27              | 5-640620-7            |
| YES      | 66.04[2.600] | 26              | 5-640620-6            |
| YES      | 63.50[2.500] | 25              | 5-640620-5            |
| YES      | 60.96[2.400] | 24              | 5-640620-4            |
| YES      | 58.42[2.300] | 23              | 5-640620-3            |
| YES      | 55.88[2.200] | 22              | 5-640620-2            |
| YES      | 53.34[2.100] | 21              | 5-640620-1            |
| YES      | 50.80[2.000] | 20              | 5-640620-0            |
| YES      | 48.26[1.900] | 19              | 4-640620-9            |
| YES      | 45.72[1.800] | 18              | 4-640620-8            |
| YES      | 43.18[1.700] | 17              | 4-640620-7            |
| YES      | 40.64[1.600] | 16              | 4-640620-6            |
| YES      | 38.10[1.500] | 15              | 4-640620-5            |
| YES      | 35.56[1.400] | 14              | 4-640620-4            |
| YES      | 33.02[1.300] | 13              | 4-640620-3            |
| YES      | 30.48[1.200] | 12              | 4-640620-2            |
| YES      | 27.94[1.100] | 11              | 4-640620-1            |
| YES      | 25.40[1.000] | 10              | 4-640620-0            |
| YES      | 22.86[.900]  | 9               | 3-640620-9            |
| YES      | 20.32[.800]  | 8               | 3-640620-8            |
| YES      | 17.78[.700]  | 7               | 3-640620-7            |
| YES      | 15.24[.600]  | 6               | 3-640620-6            |
| YES      | 12.70[.500]  | 5               | 3-640620-5            |
| YES      | 10.16[.400]  | 4               | 3-640620-4            |
| YES      | 7.62[.300]   | 3               | 3-640620-3            |
| YES      | 5.08[.200]   | 2               | 3-640620-2            |
| NO       | 71.12[2.800] | 28              | <del>2-640620-8</del> |
| NO       | 68.58[2.700] | 27              | <del>2-640620-7</del> |
| NO       | 66.04[2.600] | 26              | <del>2-640620-6</del> |
| NO       | 63.50[2.500] | 25              | <del>2-640620-5</del> |
| NO       | 60.96[2.400] | 24              | <del>2-640620-4</del> |
| NO       | 58.42[2.300] | 23              | <del>2-640620-3</del> |
| NO       | 55.88[2.200] | 22              | <del>2-640620-2</del> |
| NO       | 53.34[2.100] | 21              | <del>2-640620-1</del> |
| NO       | 50.80[2.000] | 20              | <del>2-640620-0</del> |
| NO       | 48.26[1.900] | 19              | 1-640620-9            |
| NO       | 45.72[1.800] | 18              | <del>1-640620-8</del> |
| NO       | 43.18[1.700] | 17              | 1-640620-7            |
| NO       | 40.64[1.600] | 16              | 1-640620-6            |
| NO       | 38.10[1.500] | 15              | 1-640620-5            |
| NO       | 35.56[1.400] | 14              | <del>1-640620-4</del> |
| NO       | 33.02[1.300] | 13              | 1-640620-3            |
| NO       | 30.48[1.200] | 12              | 1-640620-2            |
| NO       | 27.94[1.100] | 11              | <del>1-640620-1</del> |
| NO       | 25.40[1.000] | 10              | 1-640620-0            |
| NO       | 22.86[.900]  | 9               | 640620-9              |
| NO       | 20.32[.800]  | 8               | 640620-8              |
| NO       | 17.78[.700]  | 7               | <del>640620-7</del>   |
| NO       | 15.24[.600]  | 6               | 640620-6              |
| NO       | 12.70[.500]  | 5               | 640620-5              |
| NO       | 10.16[.400]  | 4               | 640620-4              |
| NO       | 7.62[.300]   | 3               | 640620-3              |
| NO       | 5.08[.200]   | 2               | 640620-2              |
| LEADFREE | DIM A        | NO. OF CIRCUITS | PART NO.              |

SUPERSEDED  $\nabla$

SUPERSEDED  $\nabla$

SUPERSEDED  $\nabla$

SUPERSEDED  $\nabla$

SUPERSEDED  $\nabla$

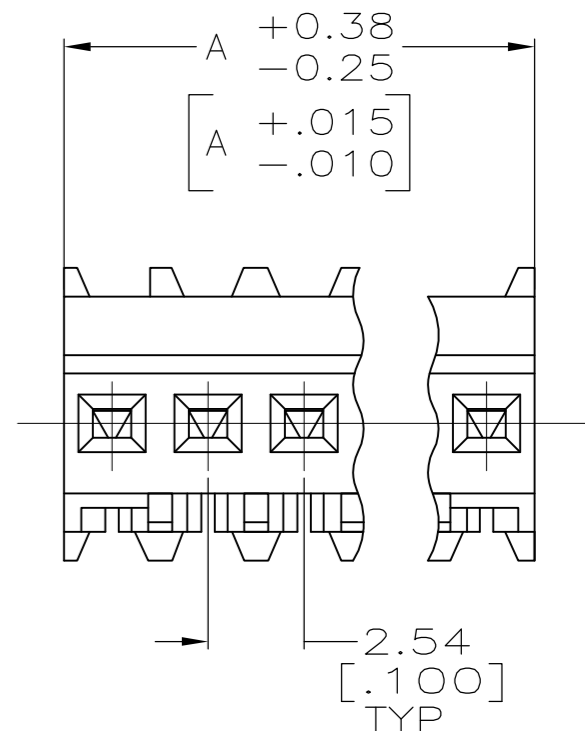
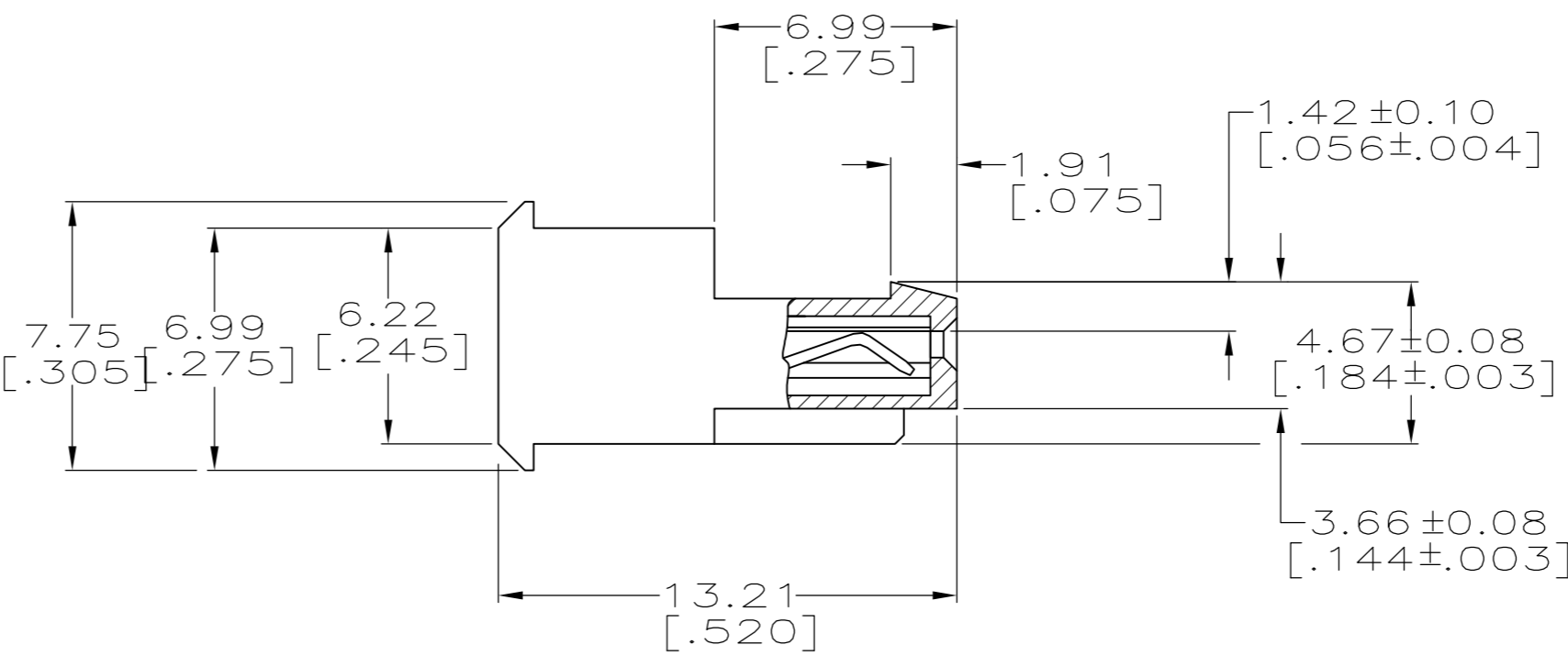
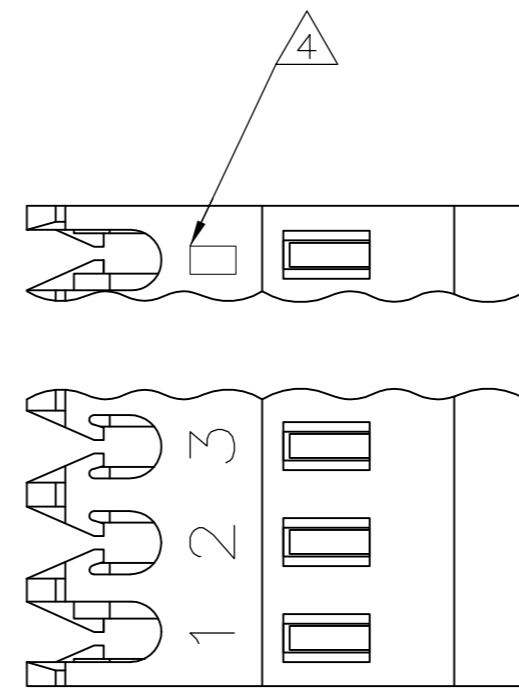

- $\nabla$  MATERIAL: CONNECTOR - NYLON UL94V-2 (RED).  
CONTACTS - 0.30[.012] THICK COPPER ALLOY BRIGHT TIN-LEAD .00203[.000080] MIN THICKNESS FOR 640620-2 THRU 2-640620-8.  
MATTE WHISKER MITIGATED TIN .00203[.000080] MIN THICKNESS OVER NICKEL UNDERPLATE FOR 3-640620-2 THRU 5-640620-8.
- 2. CONTACTS ACCEPT 22 AWG WIRE WITH 1.52[.060] MAX INSULATION DIAMETER.
- 3. CONTACTS MUST ACCEPT 0.64±0.03[.025] POST AND REMAIN LOCKED IN POSITION.
- $\nabla$  IDENTIFICATION NUMBER FOR LAST CIRCUIT MAY NOT APPEAR ON ALL ASSEMBLIES.
- 5. DIMENSIONS IN BRACKETS ARE IN INCHES.
- 6. HOUSING FEATURES ARE: FEED THRU WITH LOCKING RAMP.
- $\nabla$  OBSOLETE PARTS: OBSOLETE CIS STREAMLINING PER D.RENAUD/D.SINISI

**METRIC**

|   |  |                                  |   |                    |
|---|--|----------------------------------|---|--------------------|
| THIS DRAWING IS A CONTROLLED DOCUMENT.  |  | DWN<br>S. CARPENTER<br>11JUN2003 | Tyco Electronics Corporation<br>Harrisburg, PA 17105-3608 |                    |
| DIMENSIONS:<br>mm [INCHES]  |  | CHK<br>D. BOSSI<br>11JUN2003     | NAME<br>MTA 100 CONNECTOR ASSEMBLY,<br>22 AWG, STANDARD   |                    |
| TOLERANCES UNLESS OTHERWISE SPECIFIED:<br>0 PLC ±<br>1 PLC ±<br>2 PLC ±<br>3 PLC ± 0.13 [.005]<br>4 PLC ±<br>ANGLES ± |  | APVD<br>D. BOSSI<br>11JUN2003    | PRODUCT SPEC<br>108-1050                                  |                    |
| MATERIAL $\nabla$   |  | FINISH $\nabla$                  | APPLICATION SPEC<br>114-1019                              | RESTRICTED TO<br>- |
| CUSTOMER DRAWING  |  | SCALE<br>5:1                     | SHEET<br>1 OF 1   | REV<br>R1          |